

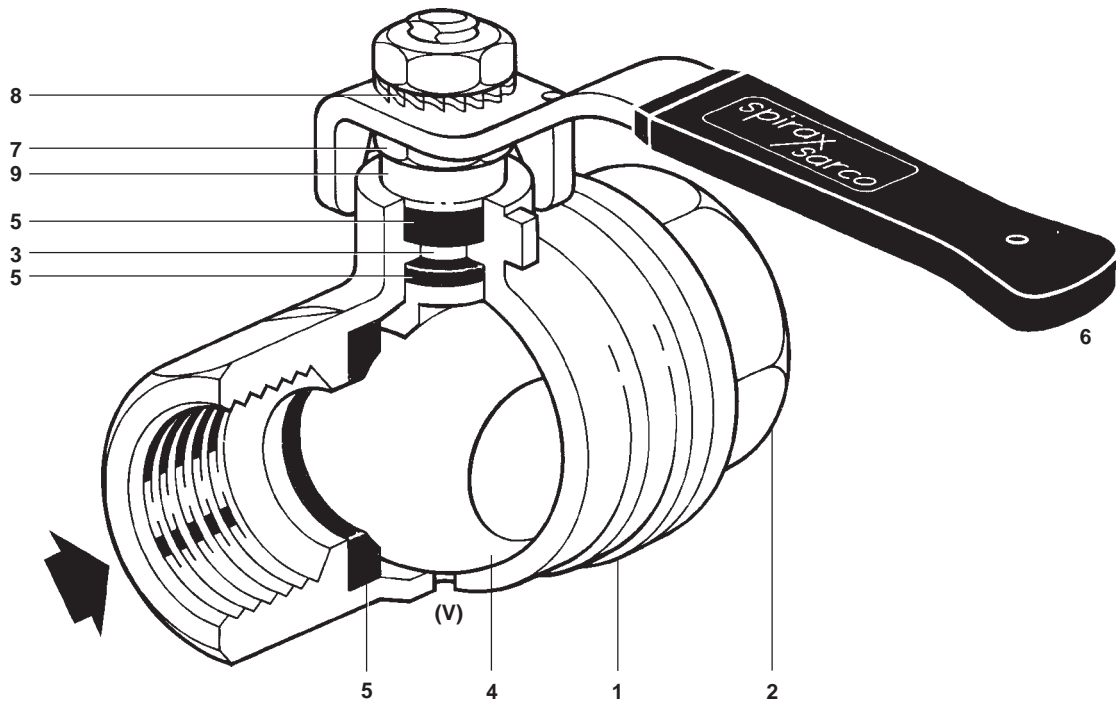

Cert. No. LRQ 0963008

ISO 9001

## Spirax-Monnier Venting and Non-venting Ball Valve



### Description

A full bore ball valve suitable for compressed air and other fluids and gases compatible with the materials of construction and pressure/temperature limits (contact Spirax Sarco for details). It is designed to provide dead tight shut-off for pneumatic and other applications.

When the valve is moved to the closed position (supply off) on self-venting models, the downstream pressure will slowly exhaust through the vent orifice (V). Self-venting models carry a flow direction arrow.

The illustration shows the self-venting valve in the closed position.

### Principal features:

- Full bore for good flow characteristics (to BS 5351).
- Suitable for inert industrial gases.
- Suitable for water and other similar fluids.
- All PTFE seals.
- Hard chrome self-cleaning ball.
- Anti blow-out stem and inner seal.

### Sizes and end connections

V - Venting  $\frac{1}{4}$ ",  $\frac{3}{8}$ ",  $\frac{1}{2}$ ",  $\frac{3}{4}$ ", and 1" screwed BSP

NV - Non-venting  $\frac{1}{4}$ ",  $\frac{3}{8}$ ",  $\frac{1}{2}$ ",  $\frac{3}{4}$ ", 1",  $1\frac{1}{4}$ ",  $1\frac{1}{2}$ " and 2" screwed BSP

### Materials

No.	Part	Material
1	Body	Brass nickel plated
2	Cap	Brass nickel plated
3	Spindle	Brass nickel plated
4	Ball	Brass chrome plated
5	Seals	PTFE
6	Handle	Steel zinc plated
7	Gland nut	Steel zinc plated
8	Spring washer	Steel zinc plated
9	Washer	Brass nickel plated

## Pressure/temperature limits

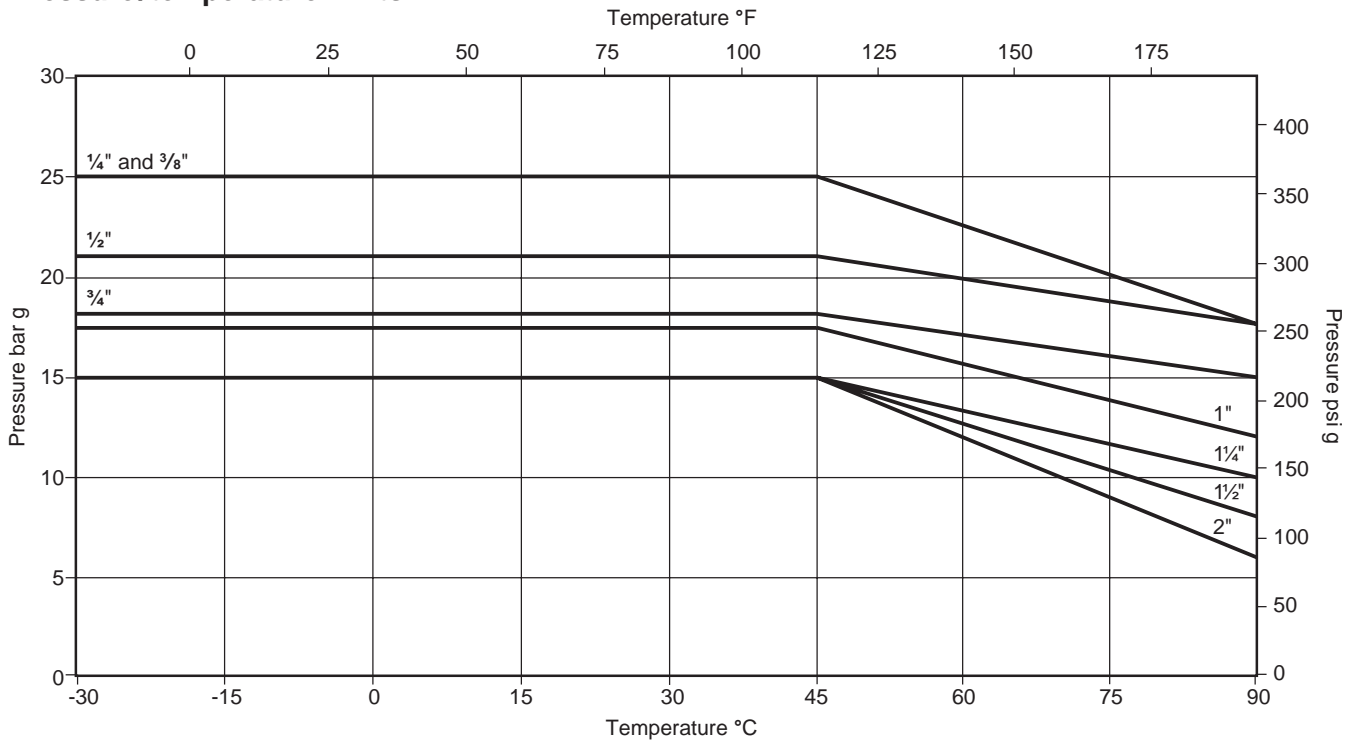

Maximum operating pressure	See graph above
Maximum operating temperature	90°C.
Minimum operating temperature	-30°C.

## K<sub>V</sub> values

Size	1/4"	3/8"	1/2"	3/4"	1"	1 1/4"	1 1/2"	2"
K <sub>V</sub>	5.4	6.0	16.3	24.5	31.0	73.0	146.0	192.6

For conversion: C<sub>V</sub> (UK) = K<sub>V</sub> x 0.963    C<sub>V</sub> (US) = K<sub>V</sub> x 1.156

## Installation

Always install the valve with the flow direction as indicated on the body of the self-venting models.

## Dimensions / weights (approximate) in mm and kg

### Non-venting types

Size	A	B	C	D	Weight
1/4"	51.5	46.0	22	98	0.19
3/8"	51.5	46.0	22	98	0.17
1/2"	60.5	49.0	27	98	0.26
3/4"	72.0	59.5	32	122	0.43
1"	84.0	63.0	41	122	0.63
1 1/4"	95.5	79.5	50	153	0.97
1 1/2"	106.0	86.0	55	153	1.37
2"	127.0	94.0	70	162	2.26

### Self-venting types

Size	A	B	C	D	Weight
1/4"	51.5	46.0	22	98	0.19
3/8"	51.5	46.0	22	98	0.17
1/2"	60.5	49.0	27	98	0.26
3/4"	72.0	59.5	32	122	0.43
1"	84.0	63.0	41	122	0.63

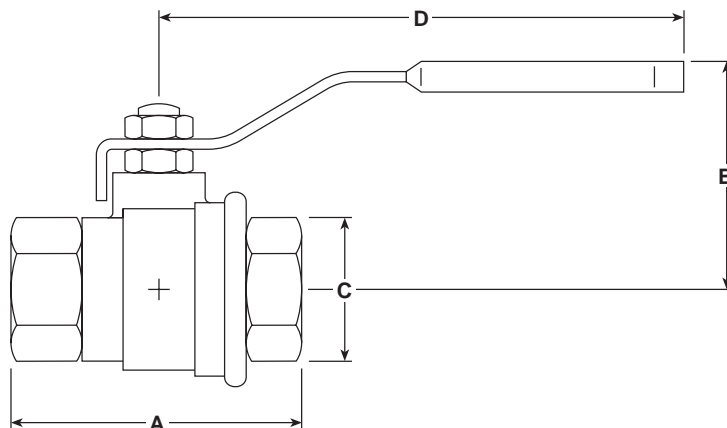

## How to order

Example: 1 off Spirax-Monnier 3/4" screwed BSP self-venting ball valve.