



Cert. No. LRQ 0963008

ISO 9001

# spirax/sarco

## BTS7

# Stainless Steel Clean Steam Trap

TI-P180-03

ST Issue 5

## Description

The Spirax Sarco BTS7 is a sealed thermostatic steam trap designed to remove condensate from clean steam systems with minimal backing up. Applications include sterile steam barriers, process vessels and CIP/SIP systems. Manufactured in 316L stainless steel with minimal crevices, it is self-draining and operates close to steam temperature. Traps are individually packaged with protective end caps and sealed in a polythene bag.

## Options

Fixed bleed to ensure fail open operation.  
Special connections to suit most piping systems.

## Standards

The BTS7 fully complies with the ASME BPE, where applicable. It also complies with the requirements of the European Pressure Equipment Directive 97/23/EC.

All wetted parts of this trap are manufactured from FDA/3-A approved materials.

## Certification

This product is available with certification to EN 10204 2.2.

**Note:** All certification/inspection requirements must be stated at the time of order placement.

## Sizes and pipe connections

1/4", 1/2", 3/4", 1" screwed BSP or NPT.

1/2", 3/4", 1" O/D x 16 swg (0.065") wall thickness tube butt weld.

### DIN 11850 (Series 1) tube butt weld ends

12 mm O/D x 1.0 mm wall thickness tube butt weld (DN10-D)

18 mm O/D x 1.0 mm wall thickness tube butt weld (DN10-D)

### ISO 1127 (Series 1) tube butt weld ends

13.5 mm O/D x 1.6 mm wall thickness tube butt weld (DN8-I)

17.2 mm O/D x 1.6 mm wall thickness tube butt weld (DN10-I)

21.3 mm O/D x 1.6 mm wall thickness tube butt weld (DN15-I)

## Pressure/temperature limits

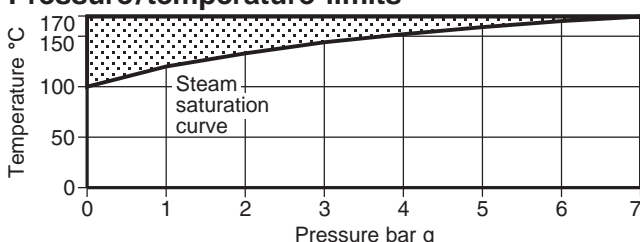

The product should not be used in this region as damage to the internals may occur.

Body design conditions		PN7
PMA	Maximum allowable pressure @ 170°C	7 bar g
TMA	Maximum allowable temperature @ 7 bar	170°C
Minimum allowable temperature		-254°C
PMO	Maximum operating pressure for saturated steam service	7 bar g
TMO	Maximum operating temperature	170°C
Minimum operating temperature		0°C
Designed for a maximum cold hydraulic test pressure of 10.5 bar g		

## Materials

No.	Part	Material
1	Body	Stainless steel AISI 316L (1.4404)
2	Element	Stainless steel AISI 316L (1.4404)

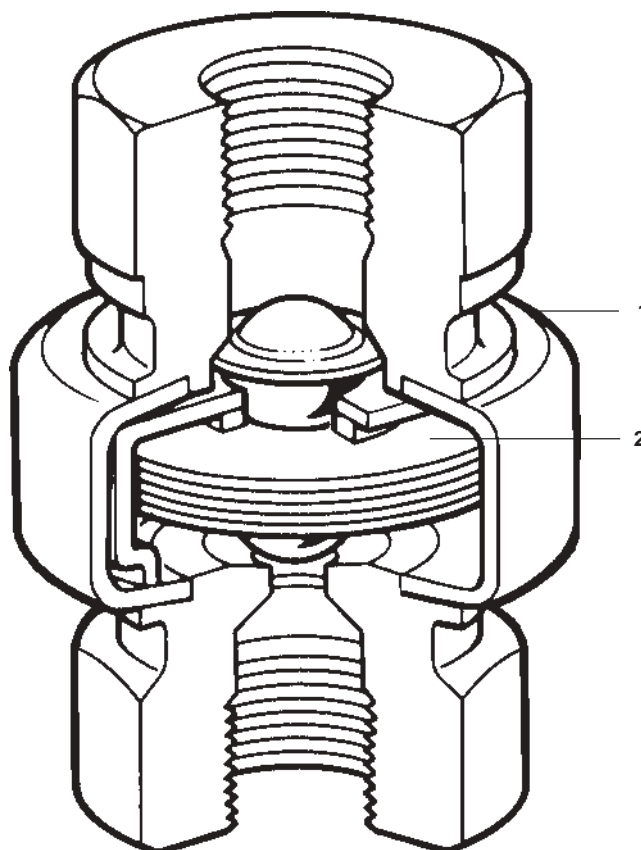

**BTS7**

with screwed connection

## Capacities

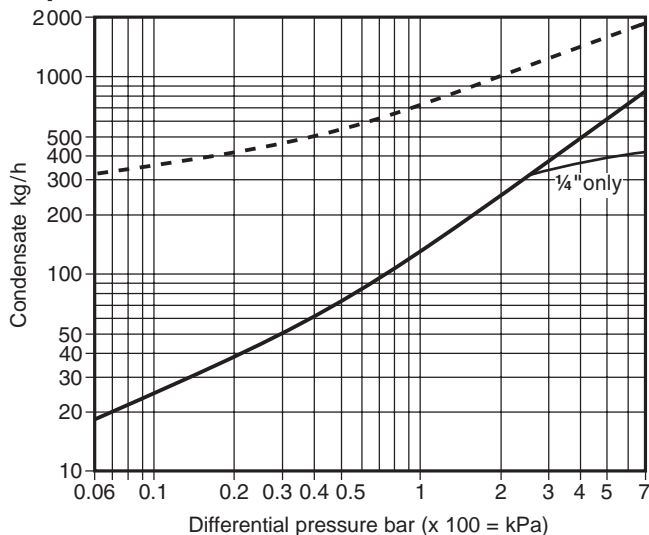

## Dimensions/weights (approximate) in mm and kg

Size	A	B	C	D	Weight	Weight
		Tube		Screwed	Tube	Screwed
1/4"	40	-	-	58	-	0.53
1/2"	40	106	40	74	0.44	0.49
3/4"	40	106	40	81	0.51	0.60
1"	40	106	40	95	0.60	0.73
DN8*	40	106	40	-	0.35	-
DN10	40	106	40	-	0.35	-
DN15	40	106	40	-	0.42	-

\*DN8 only available for ISO 1127 tube ends.

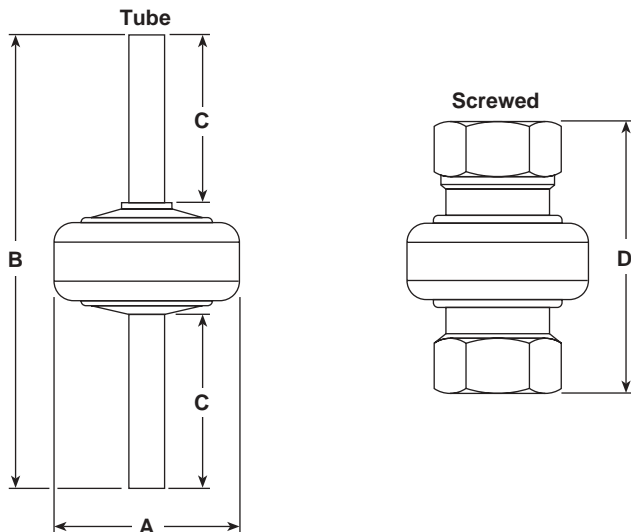

## Safety information, installation and maintenance

For full details see the Installation and Maintenance Instructions (IM-P180-05) supplied with the product.

### Installation note:

The trap is designed for installation in vertical lines with the flow downward to ensure self-draining operation. Do not expose the element to superheat conditions since over-expansion may result. Suitable isolation valves must be installed to allow for safe maintenance/replacement.

## How to order

**Example:** 1 off Spirax Sarco non-maintainable DN15 BTS7 clean steam trap with tube ends to ISO 1127, Series 1. (21.3 mm O/D x 1.6 mm wall thickness). Tangent length of tube ends to be 40 mm for ease of orbital welding. Body to be self-draining. Suitable for pressures up to 7 bar g.

## Spare parts

There are no spare parts for the BTS7.