

BTS7.1 Stainless Steel Clean Steam Trap

Description

The Spirax Sarco BTS7.1 is a sealed thermostatic steam trap designed to remove condensate from clean steam systems with minimal back up. Applications include sterile steam barriers, process vessels and CIP/SIP systems. Manufactured in 316L stainless steel with minimal crevices, it is self-draining and operates close to steam temperature. The BTS7.1 has an internal finish of 0.5 Ra whilst the external finish is 0.75 Ra. When supplied, the BTS7.1 is individually packaged with protective end caps and sealed in a polythene bag.

Options

Fixed bleed to ensure fail-open operation.

Standards

The BTS7.1 fully complies with the ASME BPE, where applicable. It also complies with the requirements of the European Pressure Equipment Directive 97/23/EC. All wetted parts of this trap are manufactured from FDA and 3-A approved material.

Certification

Certification to EN 10204 3.1 is available for the body of this product. **Note:** All certification/inspection requirements must be stated at the time of order placement.

Sizes and pipe connections

½" and ¾" with sanitary clamp connections.

Pressure/temperature limits

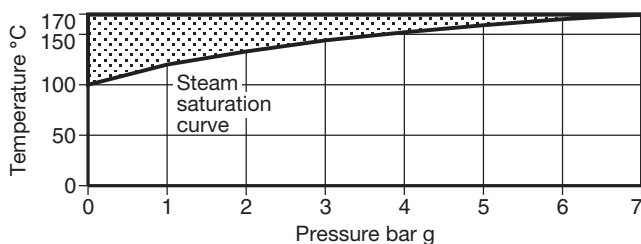

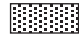
 The product should not be used in this region as damage to the internals may occur.

Body design conditions		PN7
PMA	Maximum allowable pressure	7 bar g @ 170°C
TMA	Maximum allowable temperature	170°C @ 7 bar g
Minimum allowable temperature		-254°C
PMO	Maximum operating pressure for saturated steam service	7 bar g @ 170°C
TMO	Maximum operating temperature	170°C @ 7 bar g
Minimum operating temperature		0°C
Designed for a maximum cold hydraulic test pressure of 10.5 bar g		

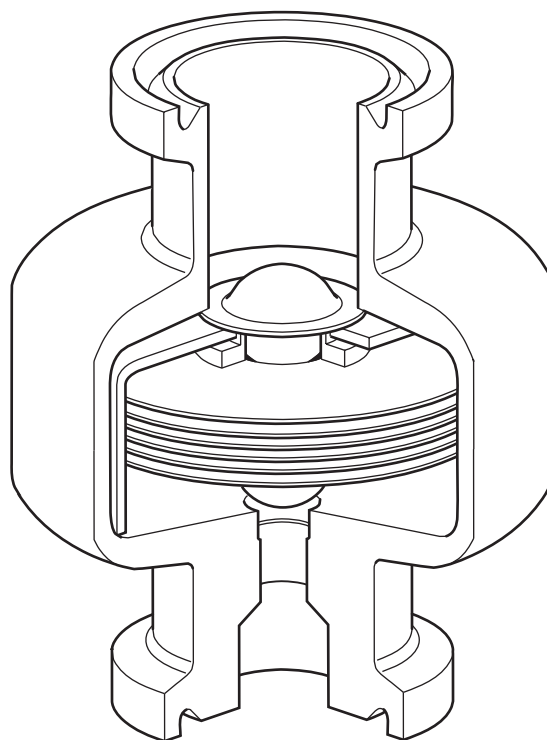

BTS7.1
with sanitary clamp connections

Materials

No.	Part	Material
1	Body	Stainless steel AISI 316L (1.4404)
2	Element	Stainless steel AISI 316L (1.4404)

Capacities

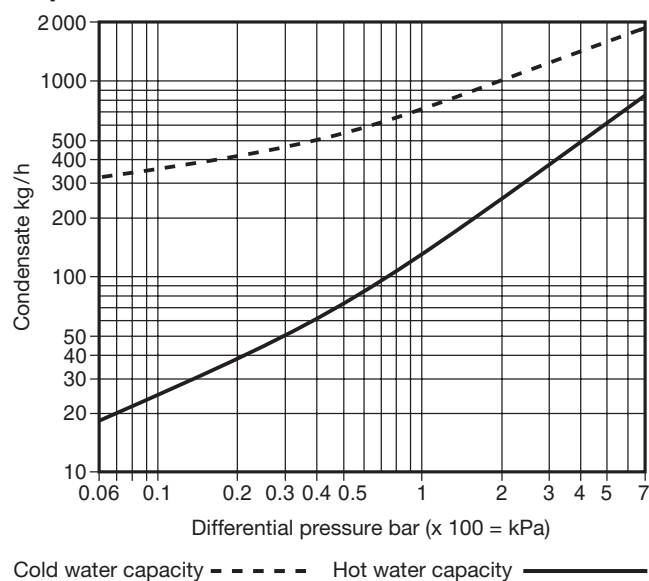

Dimensions / weights (approximate) in mm and kg

Size	A	B	Weight
1/2"	40	49	0.15 kg
3/4"	40	49	0.15 kg

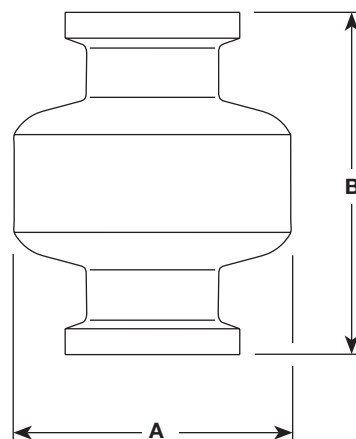

Safety information, installation and maintenance

For full details see the Installation and Maintenance Instructions (IM-P180-05) supplied with the product.

Installation note: The trap is designed for installation in vertical lines with the flow downward to ensure self-draining operation. Do not expose the element to superheat conditions since over-expansion may result. Suitable isolation valves must be installed to allow for safe maintenance/replacement.

How to order example

1 off Spirax Sarco non-maintainable 3/4" BTS7.1 clean steam trap suitable for pressures up to 7 bar g with a body that is self-draining.

Spare parts

There are no spare parts for the BTS7.1.